

THIS DRAWING MUST NOT BE SCALED AND ALL DIMENSIONS ARE TO BE CHECKED ON SITE BEFORE WORK IS COMMENCED. THE DESIGN AND DRAWING ARE THE COPYRIGHT OF THE CONSULTANTS AND MUST NOT BE USED OR REPRODUCED WITHOUT THEIR PERMISSION. ANY DISCREPANCIES ARE TO BE REPORTED IMMEDIATELY TO THE CONSULTANTS. ALL INFORMATION SHOWN ON THE DRAWING IS SUBJECT TO OBTAINING THE NECESSARY STATUTORY CONSENTS.

09/1152

- 9 SEP 2009

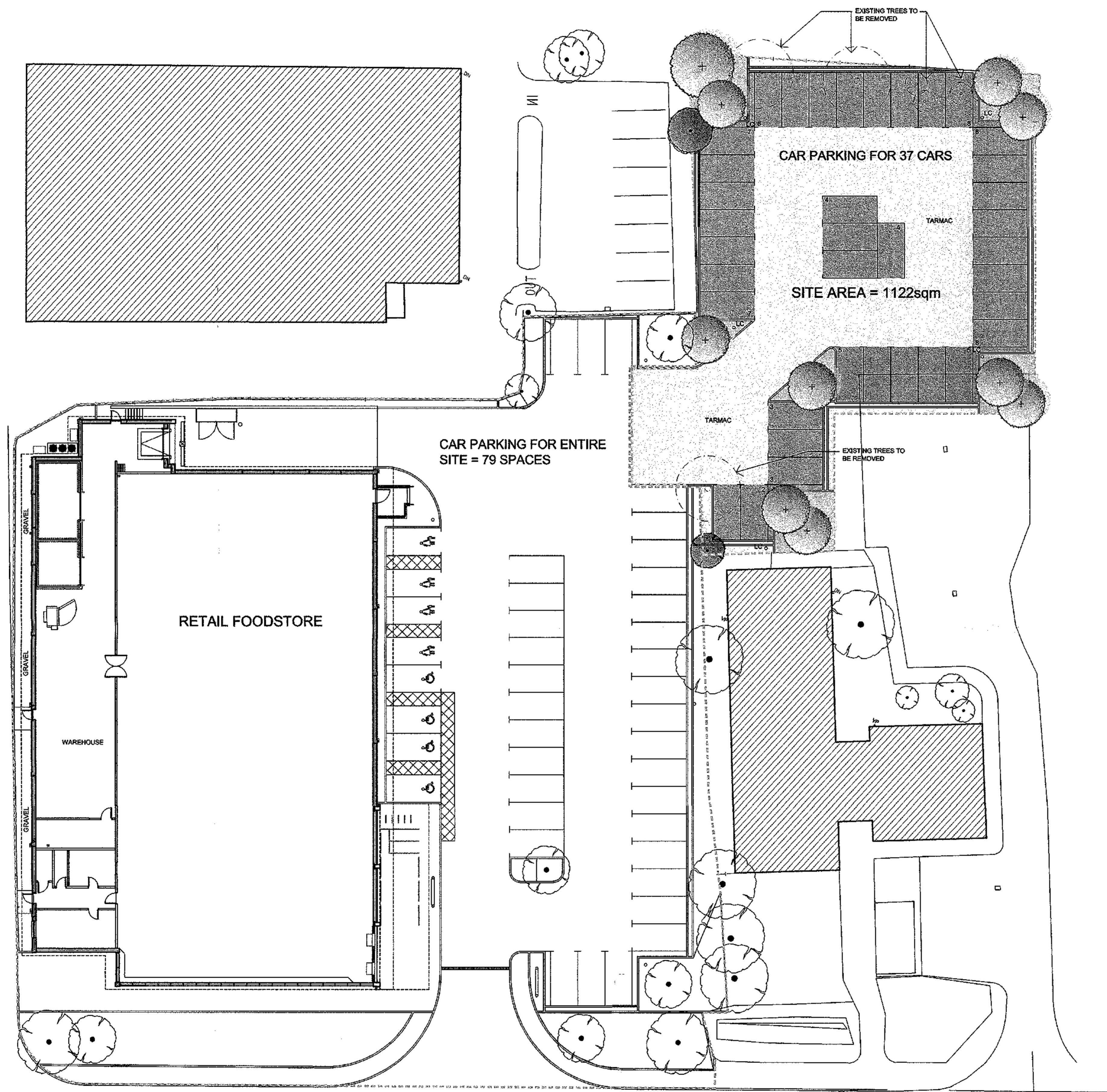

- KEY TO SITE PLAN**
- EXISTING TREES
 - PROPOSED NEW TREES
 - GRAVELED AREAS
 - GRASSED AREAS
 - TRAFFIC CIRCULATION - TARMAC
 - PARKING SPACES - TARMAC

NOTE:
 Drawing to be read in conjunction with 'Arboricultural Impact Appraisal and Method Statement' (Barrell Tree Consultancy, 2 March 2009).

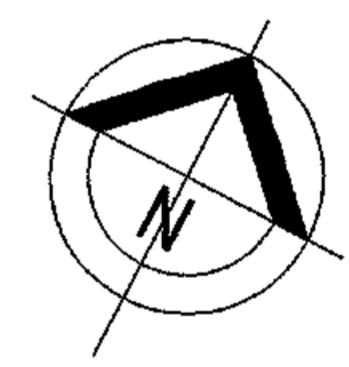

B	10.08.09	Note added
A	13.07.09	Additional kerb lines added behind car park spaces.

REVISIONS

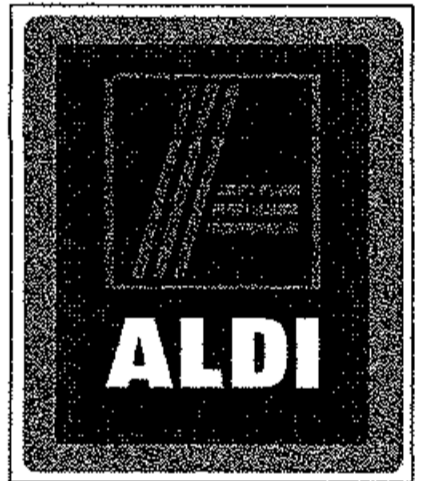

RADLEY HOUSE PARTNERSHIP
 CHARTERED ARCHITECTS
 SURVEYORS & DESIGN CONSULTANTS

▷ RADLEY HOUSE, ST. CROSS ROAD
 WINCHESTER, HAMPSHIRE SO23 9HX
 TELEPHONE 01962 842228 FAX 01962 842401

▷ 74 HIGH STREET, MAIDEN BRADLEY
 WARMINSTER, WILTSHIRE BA12 7JG
 TELEPHONE 01985 844488 FAX 01985 844745
 E-MAIL architects@radleyhouse.co.uk

JOB TITLE
 Retail Foodstore
 Alvescot Road
 Carterton

DRG. TITLE
 Proposed Site Plan

SCALE 1:200	JOB NO. 6774/3	DRG. NO. D103	REV. B
DATE June 08			